

## YOUR COUNCILLORS



## DATES FOR YOUR DIARY

### NORTH WARD

**Philip Gage**  
philip.gage@newport-pagnell.org.uk

**Roger Hornblow**  
roger.hornblow@newport-pagnell.org.uk

**Diane Kitchen**  
diane.kitchen@newport-pagnell.org.uk

**Richard Pearson**  
richard.pearson@newport-pagnell.org.uk

**Joan Sidebottom**  
joan.sidebottom@newport-pagnell.org.uk

**Phil Winsor**  
phil.winsor@newport-pagnell.org.uk

### SOUTH WARD

**Paul Alexander**  
paul.alexander@newport-pagnell.org.uk

**Binta Bah-Pokawa**  
binta.bah-pokawa@newport-pagnell.org.uk

**Roger Clarke**  
roger.clarke@newport-pagnell.org.uk

**Paul Day**  
paul.day@newport-pagnell.org.uk

**Wendy Egan**  
wendy.egan@newport-pagnell.org.uk

**Euan Henderson**  
euan.henderson@newport-pagnell.org.uk

**Mark Lombardo**  
mark.lombardo@newport-pagnell.org.uk

**Lynn Patey-Smith**  
lynn.patey-smith@newport-pagnell.org.uk

**George Purkiss**  
george.purkiss@newport-pagnell.org.uk

**Steve Urwin**  
steve.urwin@newport-pagnell.org.uk

## YOUR OFFICERS

**Shar Roselman** Town Clerk (01908) 519718  
TownClerk@newport-pagnell.org.uk

**Lesley Donovan** Responsible Financial Officer 519717  
financeofficer@newport-pagnell.org.uk

**Patrick Donovan** Deputy Clerk 519712  
deputyclerk@newport-pagnell.org.uk

**Mandy Voyde** Website & events 519710  
web@newport-pagnell.org.uk

**Sharon Bull** Allotments and community centre bookings 618756  
allotments@newport-pagnell.org.uk

**Karen Hill** Property Officer 211701  
committeeofficer@newport-pagnell.org.uk

**Claire Noone** Enquiries 618756  
towncouncilinfo@newport-pagnell.org.uk

### COUNCIL MEETINGS

**Full Council—8 pm**  
10th Sept, 8th Oct, 12th Nov.

**Public Relations and Event—8 pm**  
12th Sept, 10th Oct, 14th Nov

**Policy and Finance—7.00 or 8.00 pm**  
24th Sept, 29th Oct, 26th Nov.

**Property Management—8pm**  
5th Sept, 3rd Nov, 7th Nov.

**Sports and Recreation—7.00 pm**  
24th Sept. and Stakeholders 26th Nov.

**Devolution W/G meetings—7 pm**  
10th Sept.

### EVENTS

**2nd Sept.** Horticultural Show—2 pm URC

**4th Oct** 'Day's Musical Night'—7 pm Ousedale School

**2nd Nov** Fireworks Riverside Meadows

**24th Nov** Christmas Lights Switch-on



### COUNCIL MEETINGS

**Allotments—2.00 pm**  
18th Sept, 20th Oct.

**Town Planning Interim—7.30 pm**  
5th Sept, 3rd Oct, 7th Nov.

**Town Planning Full—8.00 pm**  
19th Sept, 24th Oct, 21st Nov.

**Business Development—1 pm**  
13th Sept, 15th Nov.

**Vintage Event Meetings—7.00pm**  
None until next year.

**Newport Pagnell in Bloom** 14th Nov.

**Health and Safety—4 pm** 25th Oct.

### EVENTS HISTORICAL SOCIETY

**4th Sept.** Milton Keynes in Camera. Part 2. A pictorial presentation by Dianne Sutton

**18th Sept.** The Great British Poster Artists—presented by Graham Twemlow

**2nd Oct.** The Golden Age of British Airships by Alastair Lawson

**16th Oct.** The Society's Collection of Photos—A selection chosen by Don Hurst

**6th Nov.** The Story of the Unknown Warrior by Roger Laing. All meetings at URC - 7.30pm

## WHAT THE TOWN PLANNING AND ENVIRONMENTAL MANAGEMENT COMMITTEE DOES AT THE TOWN COUNCIL

**Town Planning:** Milton Keynes Council (MKC) requires us to comment as appropriate on the plans deposited. They generally have regard to what we say, and our aim is to safeguard the built environment whilst agreeing to those developments considered suitable.

**Public Transport:** Our focus is the deregulated public bus services. The recent cessation of the No.1 route is a good example where we have put pressure MKC and the bus operator to reconsider the matter.

**Highways:** The maintenance and improvement of the adopted highway infrastructure is the responsibility of MKC. As matters are brought to our attention they are reported and then we await remedial action. The strategic roads are the responsibility of Highways England and this is mainly the M1 which is being upgraded to a SMART motorway.

**Environmental Management:** The key issues are noise and air pollution from the M1 including the Southbound part of the Service area. In addition, the poor condition of the river beds/ banks due to lack of maintenance. We frequently raise these matters with the Environment Agency with a mixed response.

## WHO DOES WHAT IN NEWPORT PAGNELL?

### MILTON KEYNES COUNCIL

- BENEFITS
- EDUCATION—Non-academy schools.
- ELECTIONS
- HIGHWAYS—Roads, footpaths, redways, pavements, bridleways—not national roads like A5 and M1.
- HOUSING
- LANDSCAPING
- PLANNING AUTHORITY
- RUBBISH COLLECTION
- SOCIAL NEEDS— Children, adults, elderly
- STREET & TRAFFIC LIGHTS
- WASTE

### NEWPORT PAGNELL TOWN COUNCIL

- ALLOTMENTS
- CONSULTEE ON ALL PLANNING
- COMMUNITY CENTRES
- EVENTS—Mini-music festival, vintage event, help to other events.
- GRANTS
- INFORMATION SERVICE
- MIDDLETON POOL & GYM
- NEIGHBOURHOOD PLAN
- SPORTS and RECREATION
- TOWN CENTRE FLORAL DECORATIONS
- TOWN REJUVENATION—Ranger
- YOUTH CLUB

## NEWPORT PAGNELL TOWN COUNCIL

# Town talk

Issue 88

## NEWPORT PAGNELL PARKS AND PLAY AREAS CONSULTATION

As you are probably aware, funds to borough authorities have been squeezed, making it hugely difficult for councils such as Milton Keynes Council to fund anything other than statutory services. Many such statutory services are social services, such as help to disabled children in care, help to the aged, and help to those coming out of hospital who are not yet capable of managing on their own, yet have no family to depend on. Sometimes such services are even lifesaving.

But this has meant a pinch on budgets for other services such as landscaping, and park and play area management and there is every reason to believe that this squeeze will continue and worsen.

No doubt you will have noticed the difference and this year landscaping has been particularly poor.



Grass cutting has been reduced to around 6 times a year and in rainy seasons this is clearly not enough.

There is now only one officer at Milton Keynes looking after the landscaping for the whole of Milton Keynes. Weed spraying has been reduced to once a year.



There is no preventative maintenance on trees, which are drying out rapidly in our hot summer. Signage is illegible or in some cases non-existent.

Long term, our play areas are getting old, many being built around the 1980s and there is no strategy for their refurbishment.



The Town Council has a plan—and is proposing that it takes over ownership of all the parks and play areas in the town in 2020. We have the infrastructure to manage this, and a team of active councillors and staff to ensure that things get done as they should.



In taking on the parks and play areas we will be providing not only a landscaping service, but will also be looking after litter, litter bins and graffiti in the parks, maintaining the trees, and offering a rapid response service. We will review and upgrade equipment, paths and signage and ensure that the current balance of too many small, badly maintained parks compared to large well-stocked parks is redressed.

Continued on page 3.....

## MESSAGE FROM THE MAYOR

I Chair the meetings of the Town Council and am also the Mayor which means I get to represent the Town Council at a wide range of events along with my wife Sarah, who is the Mayoress. Recent occasions have included the Strawberry Fayre, Carnival and Soapbox Derby, all fabulous events arranged by volunteers. Out of town we promote Newport Pagnell at every opportunity to help bring visitors to our town events, spectators and participants to sports clubs and customers to local business. As Mayor, I will be happy to attend any local group,

organisation, charity, church or school that has an event, if you would like me to attend please contact Sharon Bull on 01908 618756 or email: [allotments@newport-pagnell.org.uk](mailto:allotments@newport-pagnell.org.uk) The Town Council also wants to hear from local people on issues. We mention the consultation on landscaping and play areas above, but please do also talk to us about any issue that matters to you. Contact details for our team are in this newsletter. You can also find me on social media as @pauldayMK “





## VOLUNTEER LITTER PICKING EVENT— WHAT A TURNOUT!

Town residents and employees turned out in force for the litter pick event this year—the largest litter picking volunteer group in Milton Keynes. Our thanks go to Nationwide Building Society, BI Worldwide and Serco for releasing their staff to participate in this community event. They were also joined by students and parents from Tickford Park and Green Park Schools who undertook a litter pick on the same afternoon and Cedars who did one later. Sadly, Ousedale School, were unable to be involved this year.



## PLAY AREA REFURBISHMENT—CHICHELEY STREET



We received 14 responses about this proposal, and because this is a limited number we will continue the consultation during the parks and play areas consultations—dates on page 3. However feedback so far is that residents do not wish to see a blue-tooth enabled shelter on the site, or additional parking, but are generally happy to see an upgrade in play equipment. A plan excluding the blue-tooth shelter is proposed above. Multi-use games area on green tarmac – 20m long 12m wide.

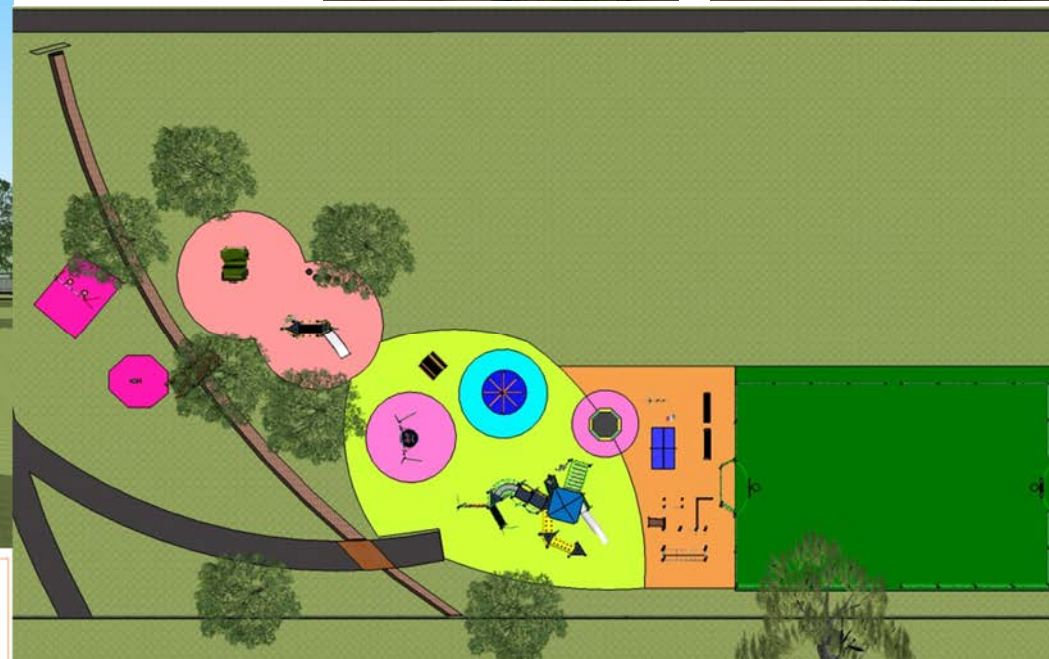

## LOOKING AFTER OUR ENVIRONMENT

### Recycling glass bottles & jars - spot the difference?



Glass bottles and jars go into the blue box but please ensure that:

- Lids are removed, cleaned and put into the clear recycling sack
- Glass is cleaned of any food residue
- Broken glass is safely wrapped then placed in the black sack or taken to a community recycling centre

Let's get it sorted!

ALL these items go into the black rubbish sack as they can't be recycled



## NEWPORT PAGNELL RANGER

In April this year, following consultation with you, we engaged a ranger to work just 10 hours a week for the community. He has been cleaning and clearing growth from signage, weed spraying, litter picking and undertaking a host of other activities.

Before ranger activity



After ranger activity



## NEWPORT PAGNELL PARKS AND PLAY AREAS CONSULTATION

Continued from page 1....

However to do so we will need to add an annual sum of £43.11 to the precept of a D Band Household. (less for smaller homes.) We are holding the following consultation events to discuss this with you and get your opinions on whether this is a step the Council should take:

- 19th September 5-6.30 pm at the Portfields Community Centre
- 22nd September 11.45 am to 1.30 pm at the URC Church Hall
- 18th October 5-6.30 pm at the Green Park Community Centre

The figure of £43.11 will also include doubling the amount of time the ranger is engaged in Newport Pagnell, to 20 hours p/wk to increase his active work in the community. We have carefully costed the sums required to limit the additional charges to local households, whilst still achieving the aims we have outlined.

There is significant evidence to show that in areas where there are green spaces that are well-looked after, the community of all ages is both happier and healthier. Play provision is crucial for young people, keeping them fitter and reducing weight gain. The options are either our parks and play areas continue to be neglected and get worse, as funding shrinks, or the Town Council takes on these liabilities. Should you be unable to attend one of the consultation events, you can make your views clear through our website: [newport-pagnell.org.uk](http://newport-pagnell.org.uk) on whether you feel the green space in our parks and play provision are important enough issues for you to warrant the additional precept. On our website you can link to Survey Monkey to answer the questionnaire electronically.

## WINNER OF THE BEST FLORAL DISPLAY BY A PUBLICAN AWARD

This year the Dolphin Pub was the winner of the Best Floral Display by a Publican Award for these stunning hanging baskets. Congratulations go to John Kaylor for his great effort in brightening up the High Street. That said, there were several exceptional displays this year, so it was a very close call for the judges.

## WINNERS OF THE BEST FRONT GARDENS AWARDS

Best large front garden is awarded to this house in the Green Park Estate.



Best small front garden award goes to owners of this property in Milton Drive.

